

Touchless & Cashless  
for Seamless Smart Parking

# TME SMART LPR PARKING



TME Smart LPR can read car plate numbers to the highest accuracy, up to 99.8% for standard car plate number, to achieve a ticketless, cashless, and touchless experience for casual and season parking.

TME Smart LPR can be integrated with multiple payment methods, for instance, eWallet Direct for seamless parking, the parking fee is auto deducted from the user's eWallet when exiting the parking site; or scan QR for online payment, or APM Autopay Machine before exit, or Payment (Exit TPK) for TNG card or credit/debit card payment at the exit lane.

#### MACHINE LEARNING

Embedded with deep learning technology that constantly improves reading accuracy.

#### VALIDATION FEATURE

Promo code made easy, suitable for shopping malls, hotels, convention halls, etc.

#### TME PARKING ANALYTICS

Comprehensive and interactive analytics charts to improve management efficiency.

#### E-INVOICE READY

e-Invoice compliance and direct links with LHDN MyInvois Portal.

#### TOUCHLESS PARKING ACCESS

Hands-free when entering and exiting parking sites.

#### CONNECT TO NEXT ACTIVITIES

Liberate data flow to build a better ecosystem for smart building.

#### ONE-STOP PMS

Consolidate all casual parking, season parking, enforcement and valet parking modules.

#### JPJ ePLATE

Support JPJePlate with 99.9% accuracy.

#### MULTIPLE PAYMENT METHODS

Support credit card, debit card, eWallet, FPX, TnG Card, etc.

#### TME EWALLET DIRECT PARTICIPANTS

Touch n' Go, Setel, more to onboard.

#### NEXT ACTIVITIES

Visitor management, security, access control, advertisement, liberate data flow to build a better ecosystem for smart building.

#### LPR MODELS

Multiple LPR models L series, M series and H series and sub-series to choose from.

#### MULTIPLE LOCATIONS

Centralize management and reporting, improve productivity.

#### AVAILABLE BACKUP PAYMENT METHODS

Auto Pay Machine, Touch n' Go card and Credit/Debit Card.



# SYSTEM DIAGRAM 1 : LPR with Multiple Payment Methods

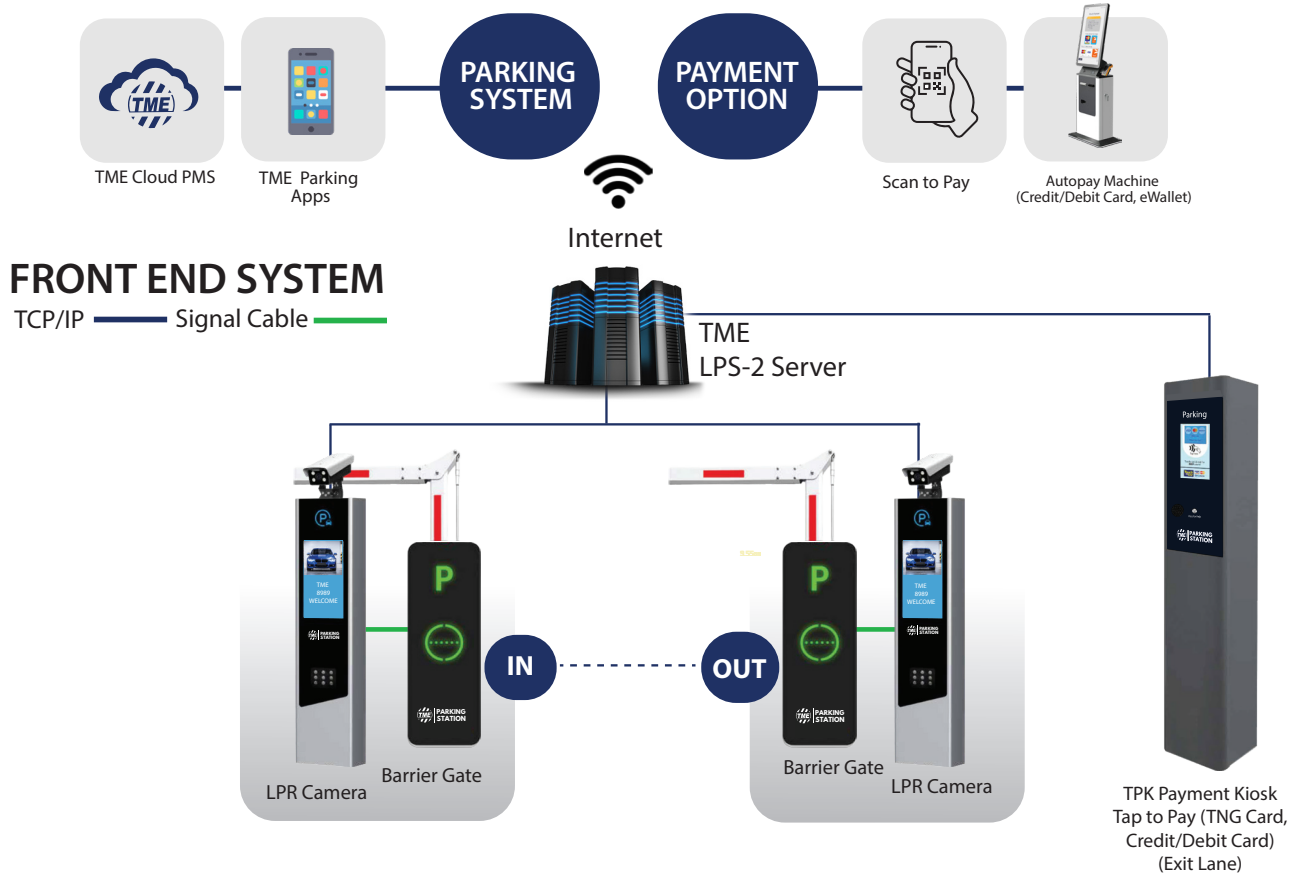

# SYSTEM DIAGRAM 2 : eWallet Direct

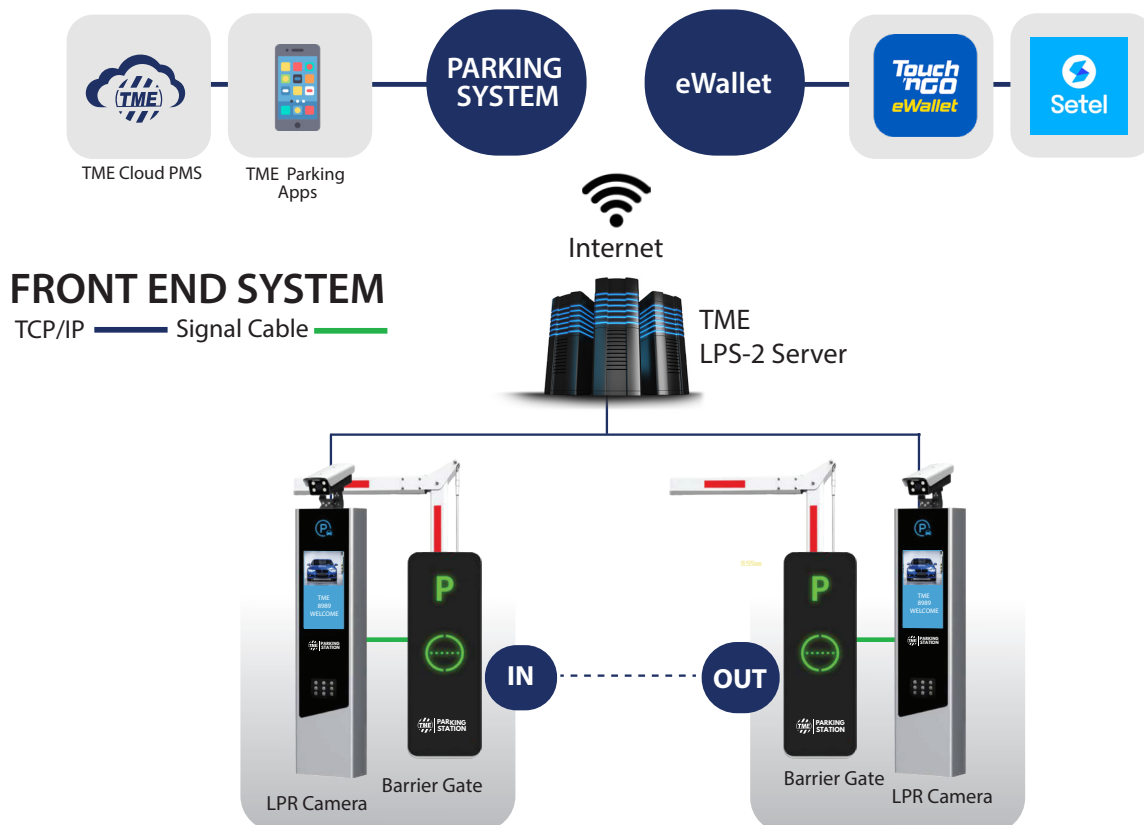

# SPECIFICATIONS

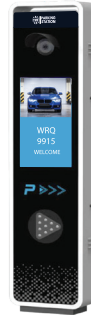

MODEL	HM Series	H2 Series	H3 Series
CAMERA	VZ Model	VZ Model	VZ Model
Camera Housing	Yes	No (Embedded module)	Yes
Image Sensor	1/2.8" starlight-level CMOS	1/2.8" starlight-level CMOS	1/2.8" starlight-level CMOS
Max Resolution	2592*1944 (5MP)	2592*1944 (5MP)	2592*1944 (5MP)
Min. illumination	Color: 0.01Lux	Color: 0.01Lux	Color: 0.01Lux
Shutter Speed & Lens	0-1msor customized (2.8~12mm lens)	0-1msor customized (2.8~12mm lens)	0-1msor customized (2.8~12mm lens)
Image Setting Video	Saturation, Brightness, Contrast, image flip, gain, exposure time	Saturation, Brightness, Contrast, image flip, gain, exposure time	Saturation, Brightness, Contrast, image flip, gain, exposure time
Compression	H265/H264/MJPEG/intelligent detection structured data output	H265/H264/MJPEG/intelligent detection structured data output	H265/H264/MJPEG/intelligent detection structured data output
Picture Format & Analytic	JPEG with configurable quality, Support LPR	JPEG with configurable quality, Support LPR	JPEG with configurable quality, Support LPR
LPR Accuracy	99.80%	99.80%	99.80%
Comprehensive Capturing Recognition Rate	≥99.99%	≥99.99%	≥99.99%
Working Temperature & Humidity	-25°C to 70°C, 90% or less (non-condensing)	-25°C to 70°C, 90% or less (non-condensing)	-25°C to 70°C, 90% or less (non-condensing)
Network Interface	1 channel 10/100Mbps adaptive RJ45	1 channel 10/100Mbps adaptive RJ45	1 channel 10/100Mbps adaptive RJ45
Communication Interface	IO output: 2 channel, IO input: 4 channel, RS485: 1 channel	IO output: 2 channel, IO input: 4 channel, RS485: 1 channel	IO output: 2 channel, IO input: 4 channel, RS485: 1 channel
Extra Deep Learning Technics	2 million starlight imaging effect, dual core processor CNN acceleration	2 million starlight imaging effect, dual core processor CNN acceleration	2 million starlight imaging effect, dual core processor CNN acceleration
LPR Algorithm Supports	Malaysia, Singapore & Thailand Car Plates	Malaysia, Singapore & Thailand Car Plates	Malaysia, Singapore & Thailand Car Plates
Power Supply	Support 9 ≤ 15VDC, standard 12V/2A	Support 9 ≤ 15VDC, standard 12V/2A	Support 9 ≤ 15VDC, standard 12V/2A
Optimal Recognition Distance	3-6m	3-6m	3-6m
Trigger Method	Ground Sense Coil or Video Stream	Ground Sense Coil or Video Stream	Ground Sense Coil or Video Stream
Output Information	Vehicle Feature Image, License Plate Image, License Plate Number, Color, Type, Passage Time	Vehicle Feature Image, License Plate Image, License Plate Number, Color, Type, Passage Time	Vehicle Feature Image, License Plate Image, License Plate Number, Color, Type, Passage Time
License Plate Anti-counterfeiting	Supported	Supported	Supported
Storage	Expandable via microSD Card Insertion	Expandable via microSD Card Insertion	Expandable via microSD Card Insertion
Secondary Development Protocol	SDK, ONMF, HTTP, RTSP	SDK, ONMF, HTTP, RTSP	SDK, ONMF, HTTP, RTSP
Adjustment Angle	Supported	Supported	Supported
Barrier Open	On Camera	On Camera	On Camera
<b>LCD PANEL</b>			
Resolution	LCD 1366*768 (18.5")	LCD 1366*768 (18.5")	LCD 1366*768 (18.5")
Color	Full Colour	Full Colour	Full Colour
Input Power	AC 220V +/- 10%	AC 220V +/- 10%	AC 220V +/- 10%
Power Supply	12V/2A	12V/2A	12V/2A
Max Power	60W	60W	60W
Stand Size	1450*333*150mm (height*width*thickness)	1450*333*150mm (height*width*thickness)	1450*333*150mm (height*width*thickness)
Working Temperature	From -20°C to +60°C	From -20°C to +60°C	From -20°C to +60°C
IP Rating	IP54	IP54	IP54
<b>BODY HOUSING &amp; FILL LIGHT</b>			
Housing Material	High-strength Carbon Steel, Sheet Metal Spraying	Dolphin-Designed, Epoxy Powder Coated	Dolphin-Designed, Epoxy Powder Coated
Protection Rate	IP65	IP65	IP65
Fill Light	Standard	Standard	Standard
Number of Lamp Beads	9 Pcs	9 Pcs	9 Pcs
Maximum Power (Lighting)	≤10W	≤10W	≤10W
Fill Light Control	Photosensitive Control	Photosensitive Control	Photosensitive Control
Fill Light Distance	Illumination >50LUX at 5m	Illumination >50LUX at 5m	Illumination >50LUX at 5m
<b>PRICING</b>			
Indication	★★	★★	★★

# FRONT END

# BACK END

Off-Street Parking Solution (Cashless)  
Visitor & Season Parking



TnG Card &  
RFID (Malaysia)



Credit/ Debit  
Card Access



QR Code (BLE 2)



License Plate  
Recognition (LPR)

On-Street Parking Solution (Cashless)

Parking App



Off-Street Parking Solution(Cash)

Parking App



## PARKING STATION

Parking Management  
System (Cloud-Based)

